

## EMBLEM BEARERS

Emblem Bearers placing emblems on pedestals before opening of the meeting say verse and then place emblem on pedestal.

ADAH:           The emblem of Adah I bear with pride  
                  Into our Chapter room tonight;  
                  And as our Sword and Veil I place  
                  May we be guided in honor and right..

RUTH:           As I bear the emblem of Ruth Tonight,  
                  My heart is filled with her beauty;  
                  And as I place our golden Sheaf,  
                  May we serve with devotion to duty.

ESTHER           The emblem of courageous Queen Esther  
                  I bear with joy and with pride;  
                  And as I place our Crown and Scepter,  
                  May loyalty and courage with us abide.

MARTHA:        It is a privilege to bear Martha's emblem  
                  A symbol of faith and hope divine;  
                  And as I place our Broken Column,  
                  May we be inspired to let our light shine.

ELECTA:        It is an honor to bear the emblem of love  
                  On Electa's pedestal to place,  
                  And as to it we turn our eyes,  
                  May we be filled with her sweet grace.

# EMBLEM BEARERS

## OPENING

### Illustration #1

(a) Emblem Bearers (EmB's) march in Chapter room (Adah & Electa march even, etc. carrying emblems.

(b) EmB's stand behind star point chairs, facing altar holding emblems.

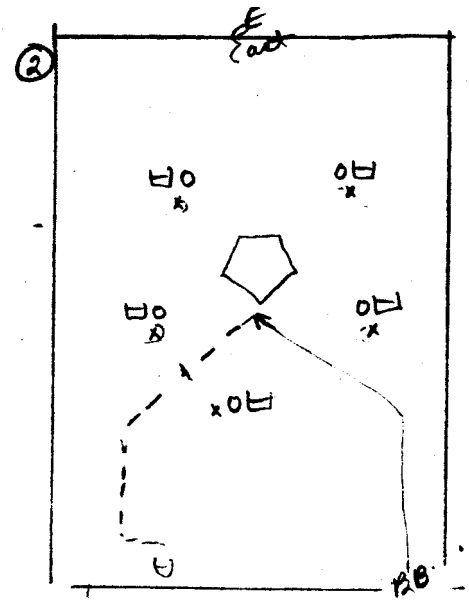
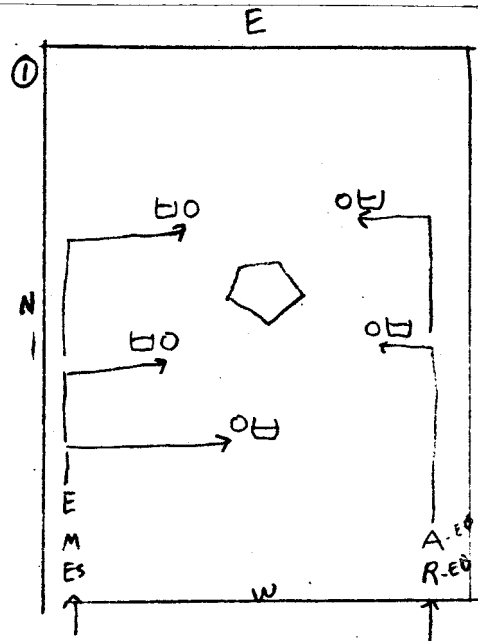

### Illustration #2

(a) Bible bearer marches in with Bible, places it on altar, marches to place in Chapter room.

(b) When Bible bearer breaks line between Martha & Electa, EmB's place emblems on pedestals. (All EmB's "key" off of Adah so all will go smoothly.

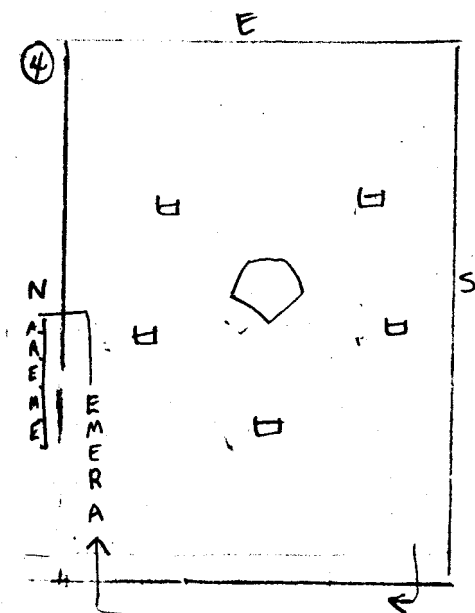
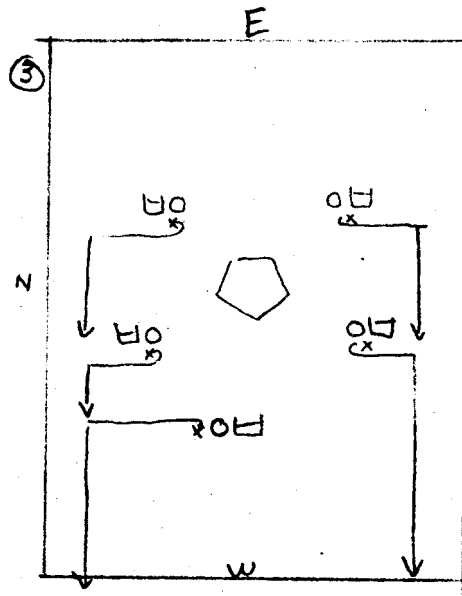

### Illustration #3

(a) Adah EmB turns and all EmB's turn in unison and march out of Chapter room on marching line.

### Illustration #4

(a) All reassemble (Electa, Martha, Es her, Ruth, Adah) and immediately all march, single file,, back in to Chapter room thru Preparation room door, and all sit together in order.

OPTIONS As each EmB places emblem on pedestal, beginning with Adah, a marrator could say a short verse on each emblem.

EMBLEM BEARERS

CLOSING

W.M. "The Emblem bearers will retire the Emblems"

Illustration #1

The EmB's stand and march to positions at back of star point chairs, facing altar.

W.M. instructs the Bible Bearer.

Illustration #2

Bible Bearer marches to Altar, picks up Bible and marches (1) out Chapter room door, (Ill 3a) or (2) to S. E., to deposit Bible and be ready to march out behind Chapter officers in closing march (Ill 3a)

Illustration #3

When Bible Bearer "breaks line" between Ruth and Esther the EmB's pick up their emblems, turn in unison and follow Bible Bearer.

NOTE: If Bible Bearer retires thru Chapter room door: Ruth EmB follows Bible Bearer, then Adah EmB, then Esther, Martha & Electa.

Also NOTE: If they (EmB's) follow Bible Bearer to S.E., as Bible Bearer gets to Adah's station, Adah EmB steps in behind her and so on- then Bible Bearer and EmB's march out behind officers at closing.

OPTIONS: 1. EmB's march to positions.

2. EmB's pick up emblems.

3. Then Bible Bearer picks up Bible and returns it.

4. EmB's follow

OR Bible Bearer picks up Bible, remains holding Bible at Altar, while a short poem is read (or a song) then resumes march.

IDEA In one Chapter all EmB 's wore identical white organdy pinafore aprons (very pretty) also could wear a colored ribbon or sash..

